

ITEM NO.	PART NUMBER	DESCRIPTION	QTY.
1	171510	1000L HORIZONTAL BAFFLED SLIMLINE TANK	1
2	521013	AB AIRGAP TURRET - UP TO 2" INLET	1

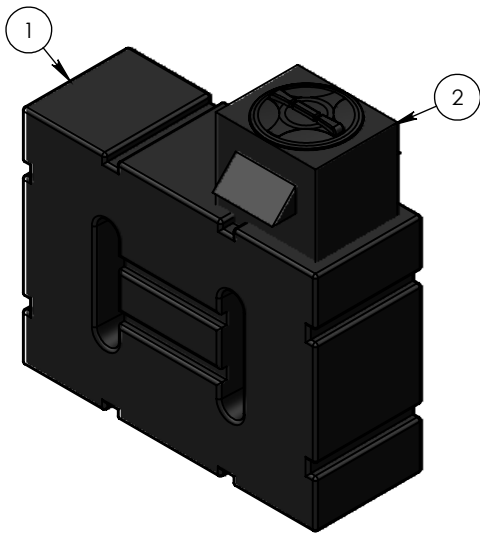

LEFT ISO VIEW  
SCALE 1 : 30

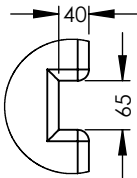

DETAIL A  
SCALE 1 : 10

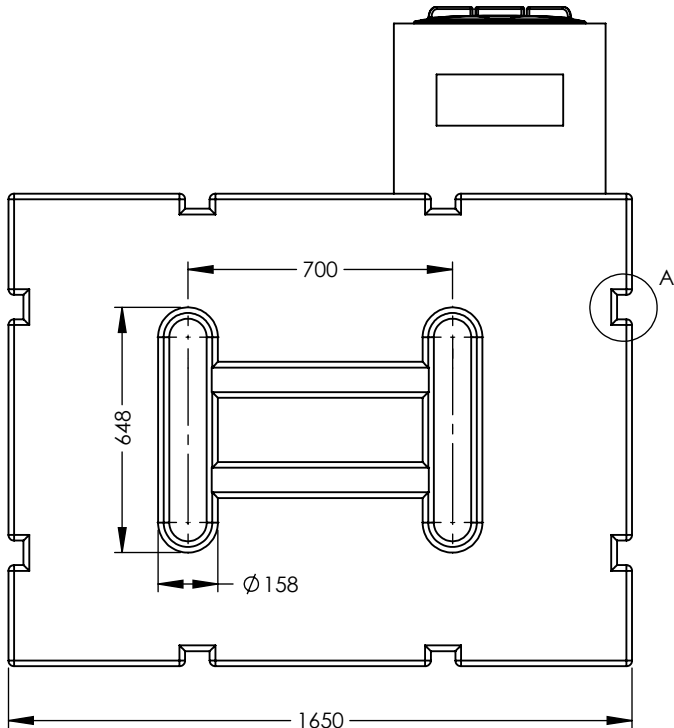

LEFT VIEW

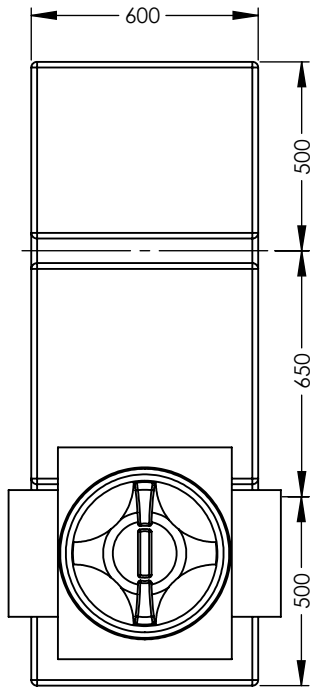

PLAN VIEW

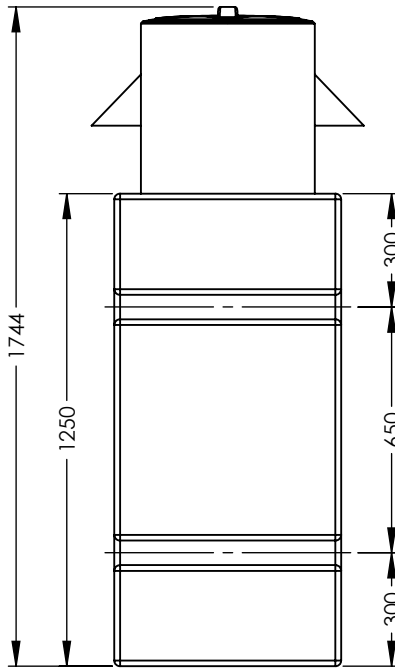

FRONT VIEW

DESIGN DATA			
DESIGN PRESSURE: ATMOSPHERIC		MAXIMUM CAPACITY (LTRS):	
DESIGN TEMPERATURE: 40°C		WORKING CAPACITY (LTRS):	
WORKING PRESSURE: ATMOSPHERIC		APPROX. WEIGHT FULL (KGS):	
WORKING TEMPERATURE: 40°C		APPROX. WEIGHT EMPTY (KGS):	
MOULDED LIFTING LUGS: 4 - 0°, 90°, 180° & 270°			
METHOD OF SUPPORT: FIRM, FLAT, FULLY SUPPORTING BASE OF CONCRETE OR OTHER SUITABLE MATEREAL			
MATERIAL DATA			
MATERIALS OF CONSTRUCTION:			
MATRIX REVOLVE N-307. REVOLVE IS A HIGH DENSITY (0.939 g/cm3), LOW MELT (3.5 g/ 10 min) HEXENE POLYETHYLENE GRADE FOR ROTOMOULDING. THE GRADE IS FULLY PROTECTED AGAINST THERMAL AND LIGHT DEGRADATION: N-307 IS UV10 STABILISED.			
INSPECTION AND TESTING			
WORKS TEST: ALL TANKS ARE THICKNESS TESTED BY ULTRASOUND AFTER DEMOULD IN ADDITION AIR SUPPORTED LEAK TEST ARE CARRIED OUT ON FLANGE LINES.			
NOTE SECTION			